

**SEATING:** 249 people

**FURNITURE**

- 30 60" round dining tables with 8 chairs at each = 240 seats for guests
- 3 24" x 96" dining tables with 3 chairs at each = 9 seats on stage
- 4 30" x 96" buffet food service tables
- 1 lectern (optional)
- 1 set of portable steps for left side of stage (optional)

All furniture listed above is included in the rental rate.

The seating capacity using this room configuration is the maximum allowable by fire safety regulations and for ADA compliance. Renaissance Centre staff are happy to work with you to accommodate different seating arrangements.

Any event that is ticketed and open to the public will require a barrier from food and a licensed caterer.



wakeforestnc.gov/  
 renaissance-centre.aspx

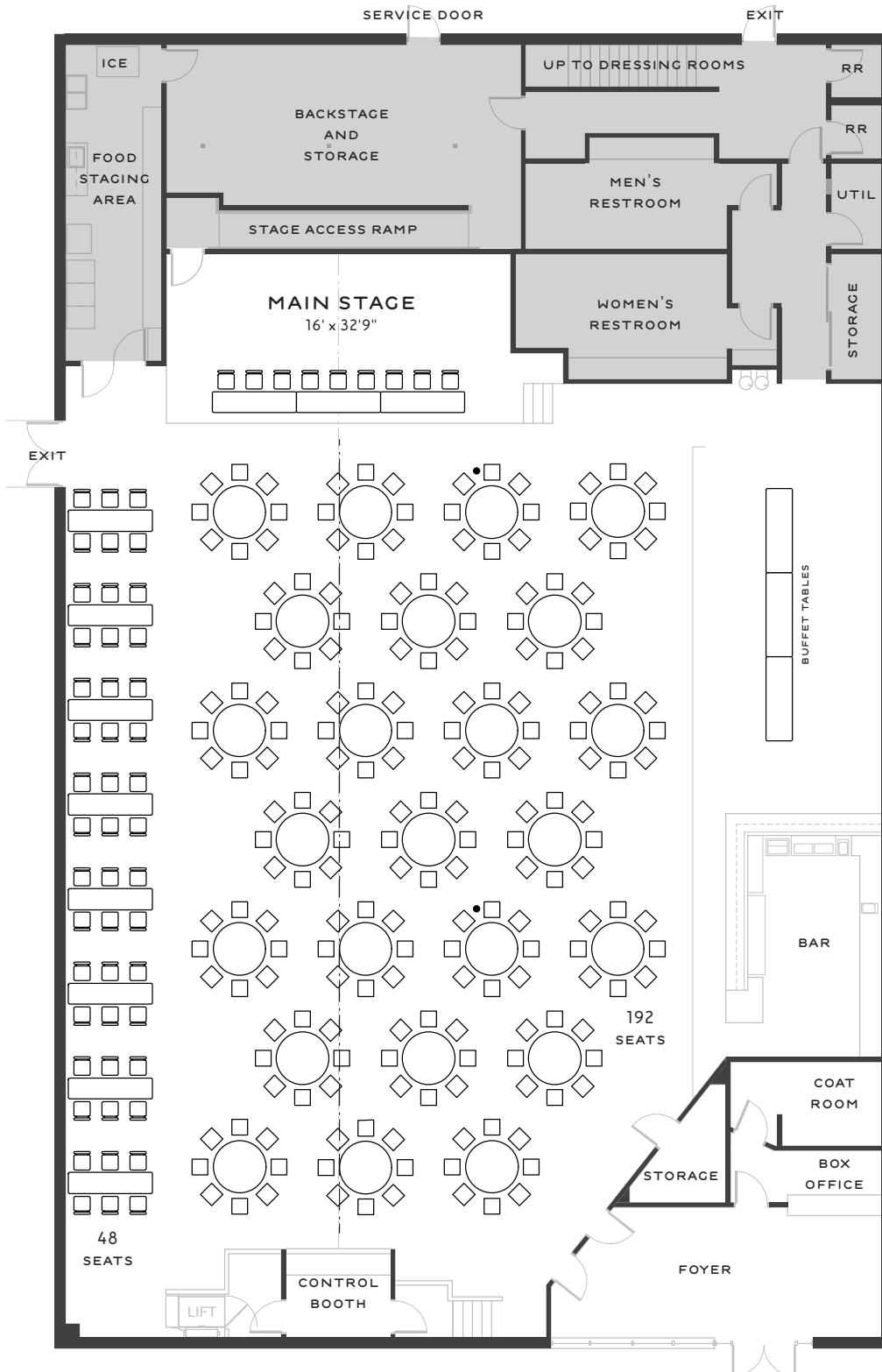

**SEATING:** 249 people

**FURNITURE**

- 24 60" round dining tables with 8 chairs at each = 192 seats for guests
- 8 24" x 96" dining buffet tables with 6 chairs at each = 48 seats for guests
- 3 24" x 96" dining tables with 3 chairs at each = 9 seats on stage
- 3 30" x 96" food buffet tables
- 1 lectern (optional)
- 1 set of portable steps for left side of stage (optional)

All furniture listed above is included in the rental rate.

The seating capacity using this room configuration is the maximum allowable by fire safety regulations and for ADA compliance. Renaissance Centre staff are happy to work with you to accommodate different seating arrangements.

Any event that is ticketed and open to the public will require a barrier from food and a licensed caterer.



wakeforestnc.gov/  
 renaissance-centre.aspx

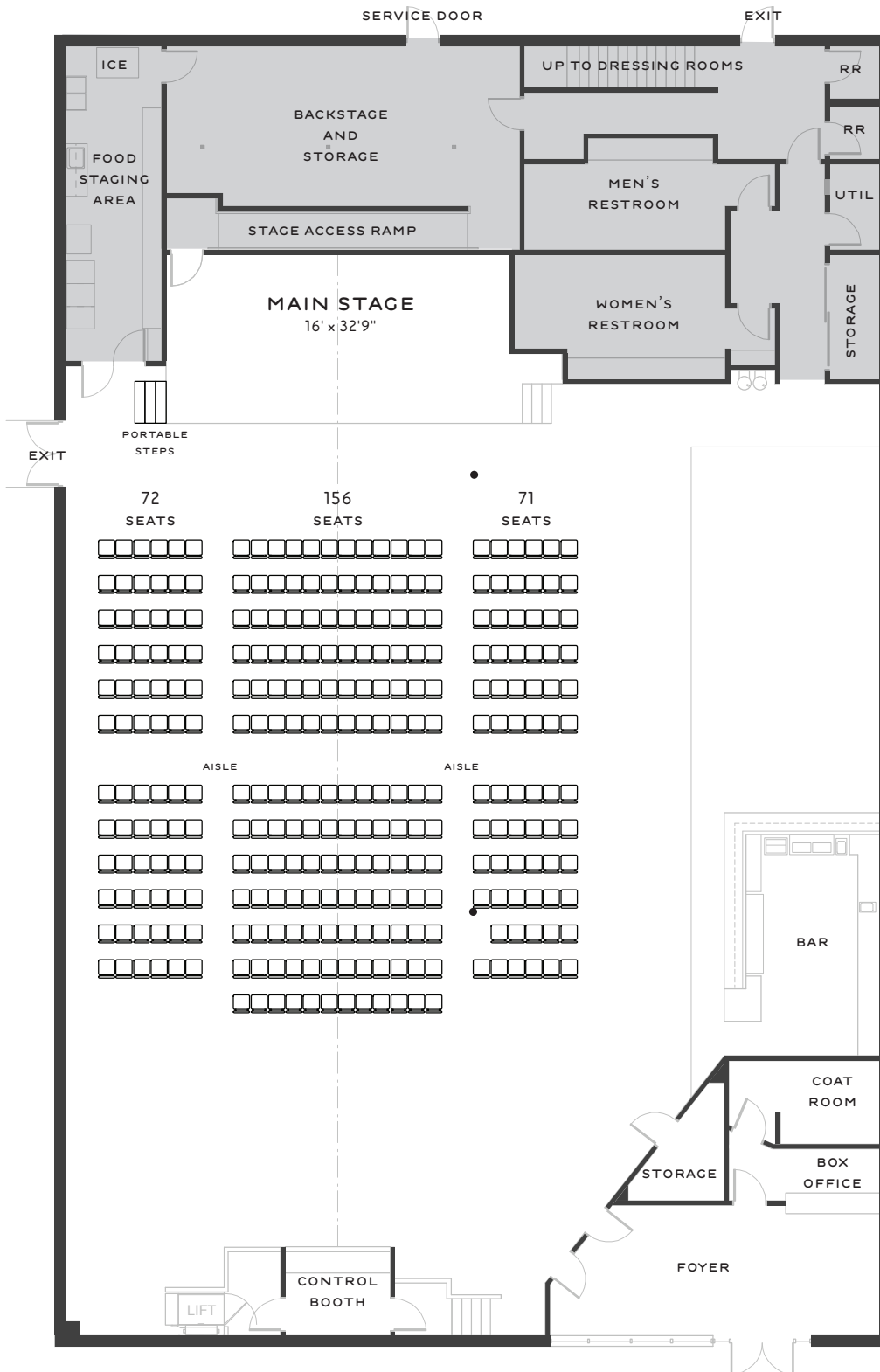

**SEATING:** up to 300 guests

**FURNITURE**

- 300 chairs in audience
- 1 set of portable steps
- 1 lectern (optional)

All furniture listed above is included in the rental rate.

This room configuration abides by fire safety regulations and is ADA compliant. Renaissance Centre staff are happy to work with you to accommodate different seating arrangements.



wakeforestnc.gov/  
renaissance-centre.aspx

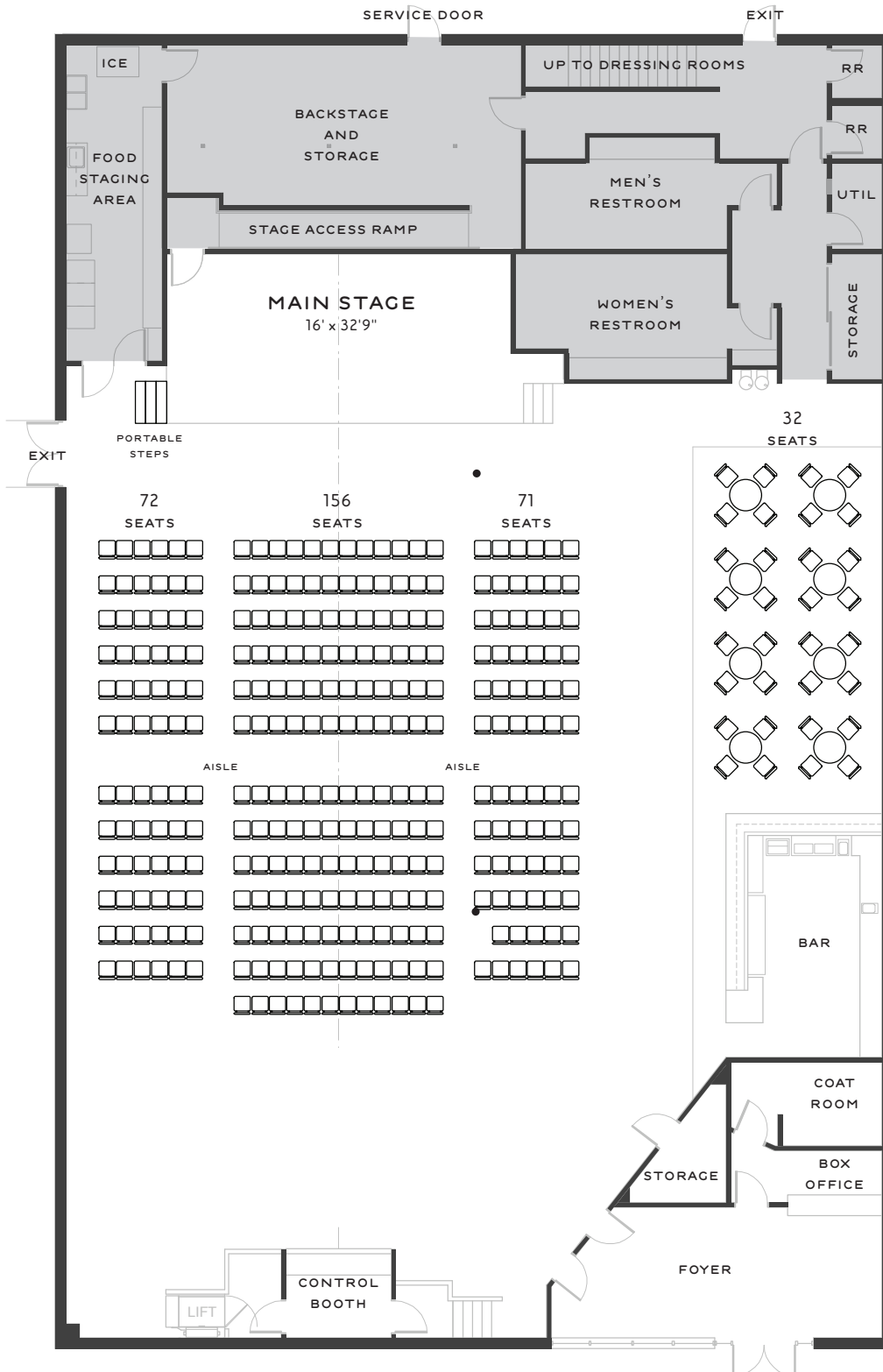

**SEATING:** 331 guests

**FURNITURE**

- 299 chairs in audience
- 8 bar service tables (low-top) with 4 chairs at each = 32 seats
- 1 set of portable steps
- 1 lectern (optional)

All furniture listed above is included in the rental rate.

This room configuration abides by fire safety regulations and is ADA compliant. Renaissance Centre staff are happy to work with you to accommodate different seating arrangements.



wakeforestnc.gov/  
 renaissance-centre.aspx

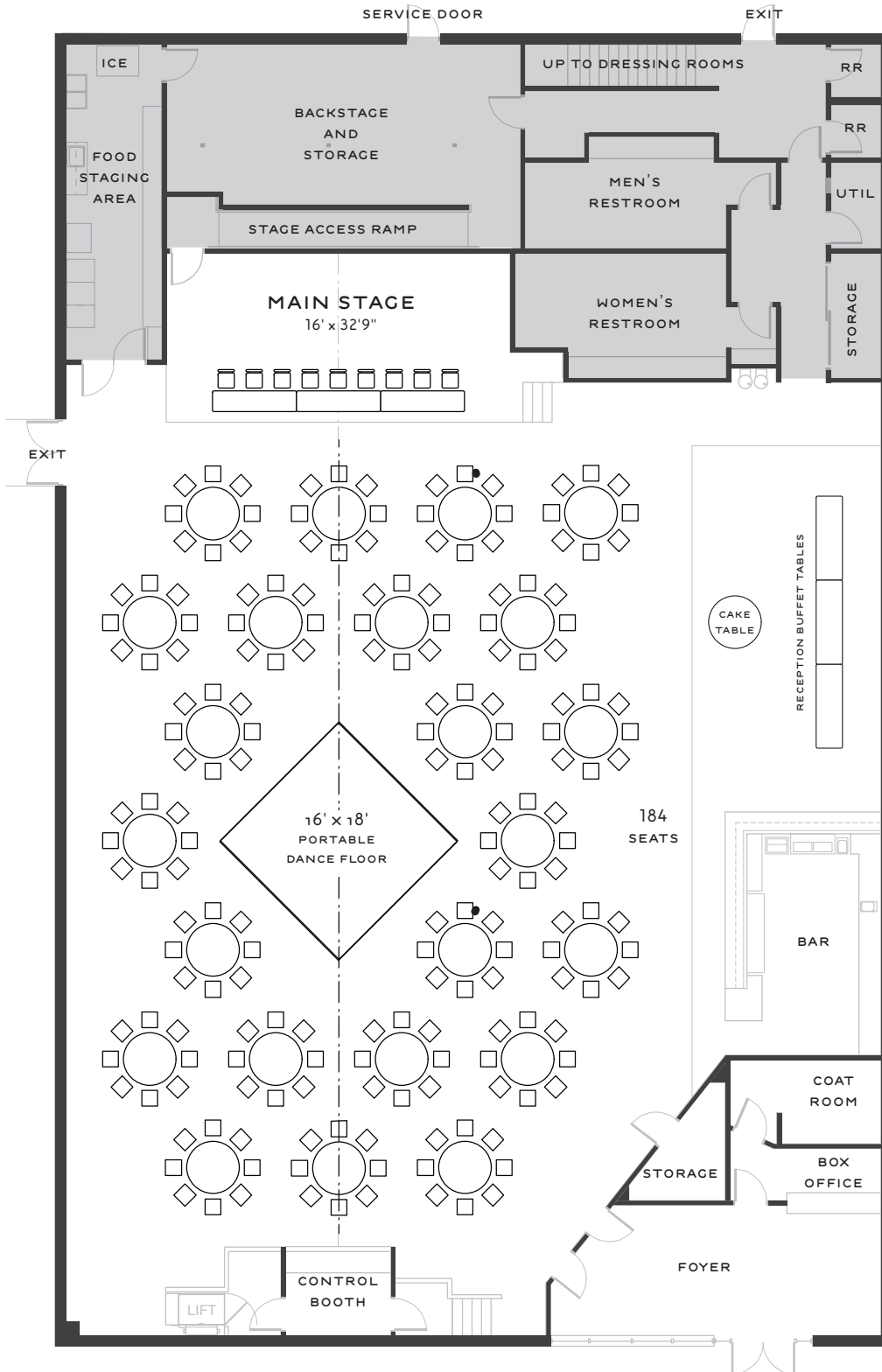

**SEATING:** 193 people

**FURNITURE**

- 23 60" diameter round tables with 8 chairs at each = 184 seats for guests
- 3 24" x 96" tables on stage with 3 chairs at each = 9 seats for honored guests
- 1 60" diameter cake table
- 3 30" x 96" buffet tables
- 1 16' x 18' portable dance floor
- 1 lectern (optional)
- 1 set of portable steps for left side of stage (optional)

All furniture listed above is included in the rental rate.

The seating capacity using this room configuration is the maximum allowable by fire safety regulations and for ADA compliance. Renaissance Centre staff are happy to work with you to accommodate different seating arrangements.



wakeforestnc.gov/  
renaissance-centre.aspx

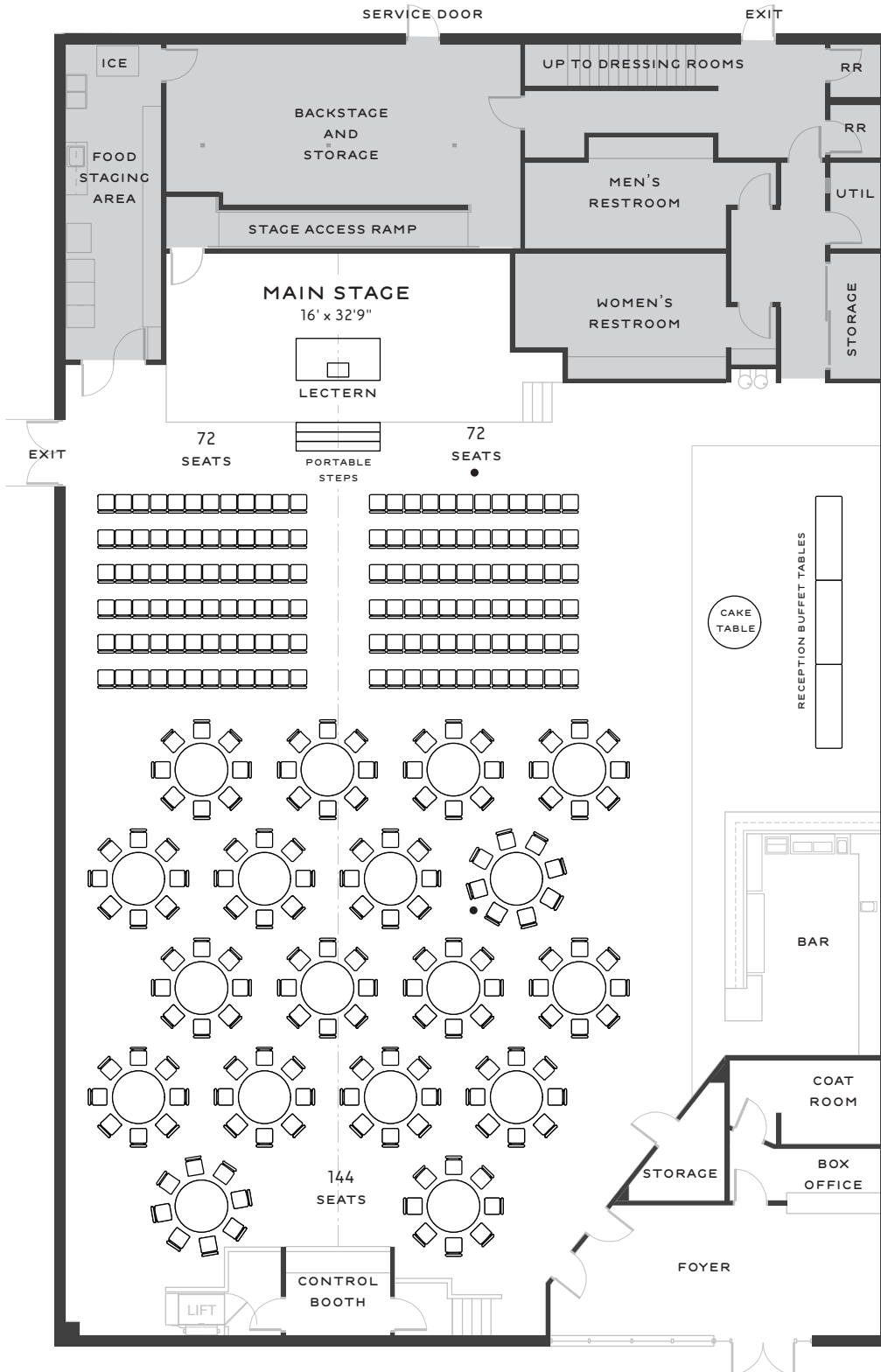

**SEATING:** 144 guests

**FURNITURE**

- 144 chairs in audience
- 18 60" diameter tables with 8 chairs at each = 144 seats in reception area
- 1 60" diameter cake table
- 3 30" x 96" buffet tables
- 1 lectern
- 1 portable riser
- 1 set of portable steps
- 1 16' x 18' portable dance floor (optional, may be included in floorplan)

All furniture listed above is included in the rental rate.

The seating capacity using this room configuration is the maximum allowable by fire safety regulations and for ADA compliance. Renaissance Centre staff are happy to work with you to accommodate different seating arrangements.



[wakeforestnc.gov/renaissance-centre.aspx](http://wakeforestnc.gov/renaissance-centre.aspx)

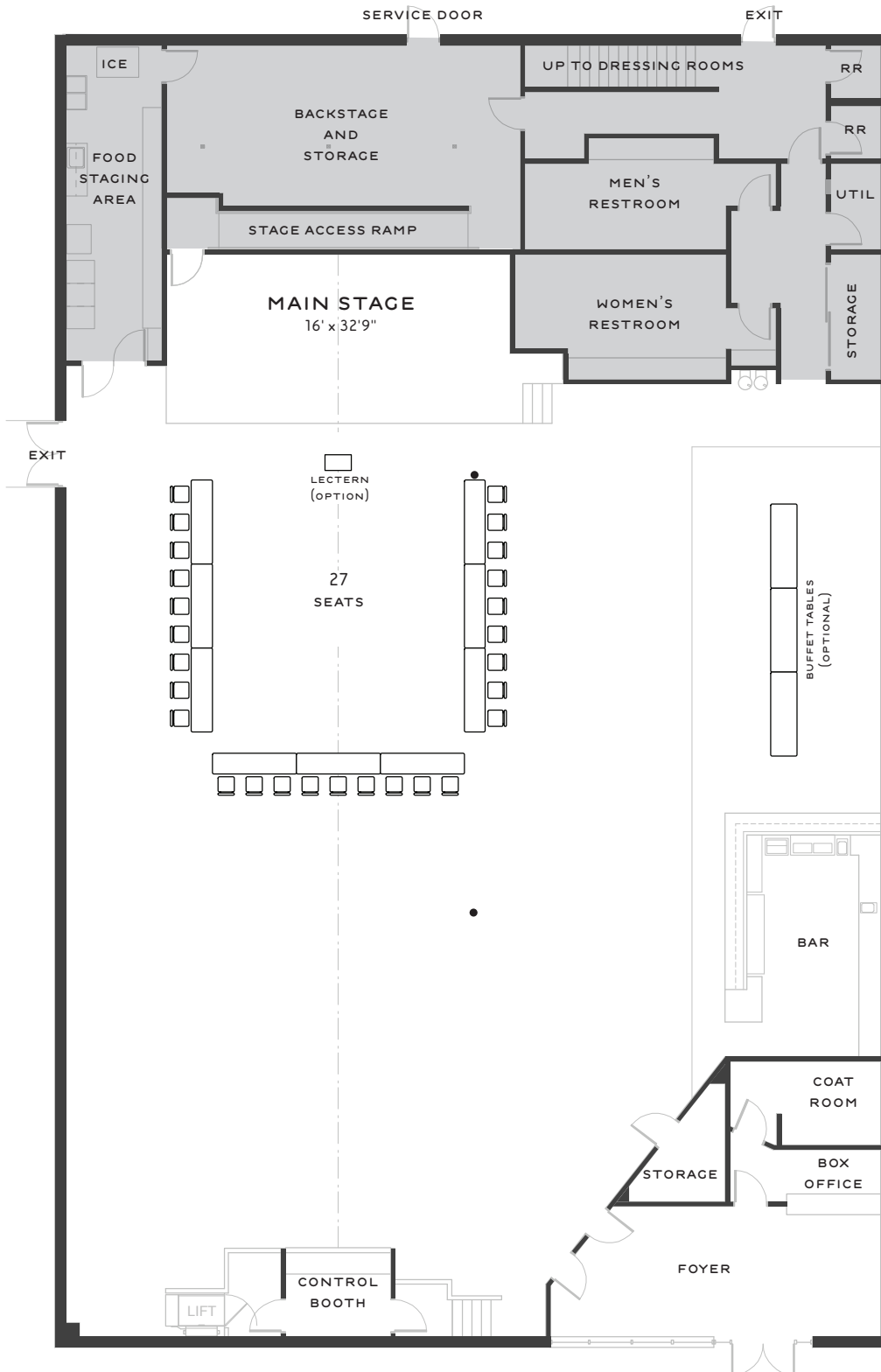

**SEATING:** flexible; sample shows 27 people

**FURNITURE**

- 9 24" x 96" meeting tables with 3 chairs at each = 27 seats for participants
- 3 30" x 96" food buffet tables
- 1 lectern

All furniture listed above is included in the rental rate.

This room configuration abides by fire safety regulations and is ADA compliant. Renaissance Centre staff are happy to work with you to accommodate different seating arrangements.



[wakeforestnc.gov/renaissance-centre.aspx](http://wakeforestnc.gov/renaissance-centre.aspx)

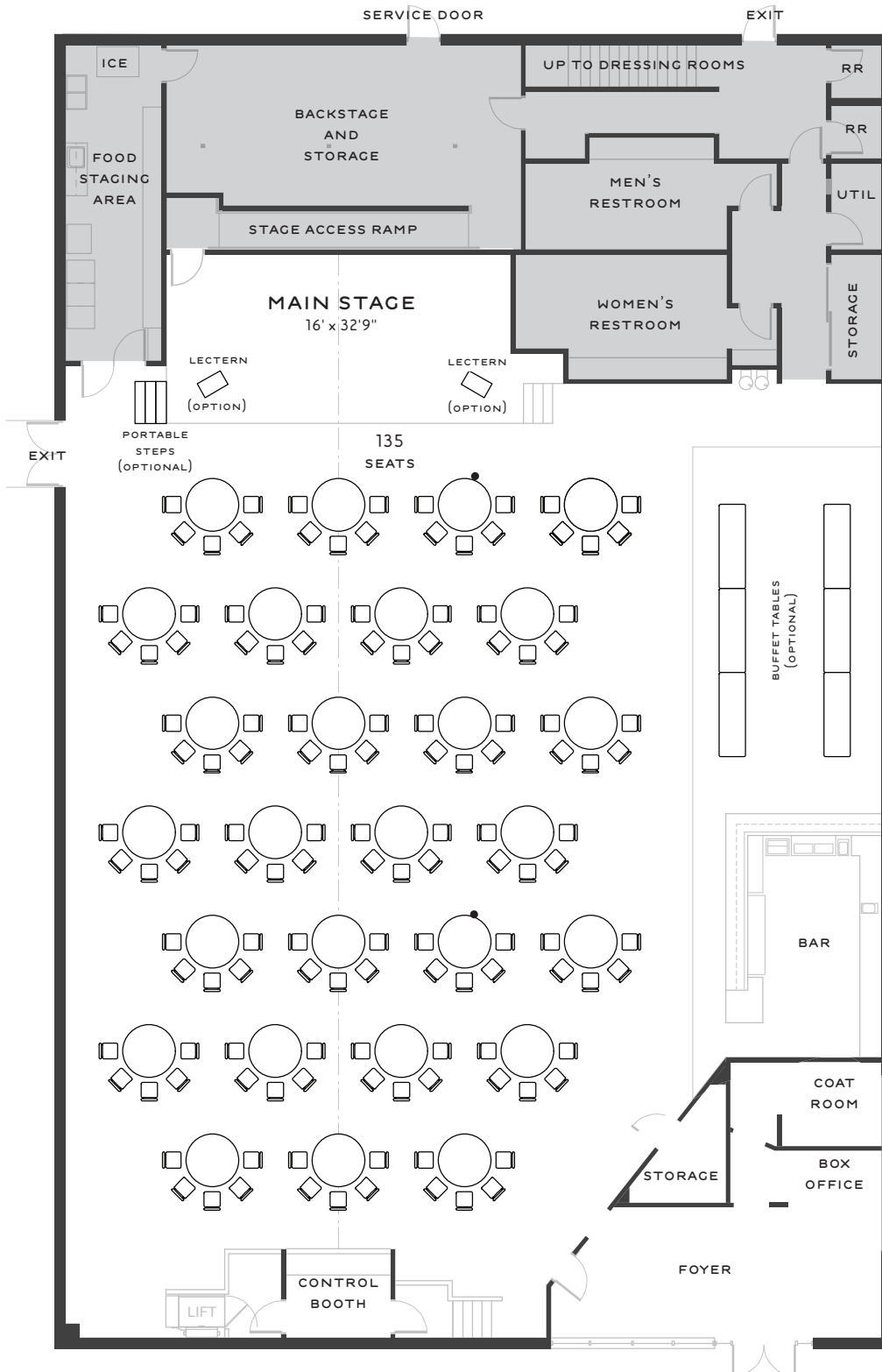

**SEATING:** 135 people

**FURNITURE**

- 27 60" diameter tables with 5 chairs at each = 135 seats for participants
- 6 30" x 96" food buffet tables
- 1 lectern
- 1 set of portable steps

All furniture listed above is included in the rental rate.

The seating capacity using this room configuration is the maximum allowable by fire safety regulations and for ADA compliance. Renaissance Centre staff are happy to work with you to accommodate different seating arrangements.



[wakeforestnc.gov/renaissance-centre.aspx](http://wakeforestnc.gov/renaissance-centre.aspx)